



MÜNSTER OSNABRÜCK  
INTERNATIONAL AIRPORT

# WELCOME AT MÜNSTER/ OSNABRÜCK INT. AIRPORT

The modern airport for North Rhine Westfalia,  
Lower Saxony and the eastern parts of the  
Netherlands

FMO FLUGHAFEN  
MÜNSTER/OSNABRÜCK GMBH  
AIRPORTALLEE 1  
48268 GREVEN

TEL +49 (0) 2571 94-0  
FAX +49 (0) 2571 94-3364  
INFO@FMO.DE  
WWW.FMO.DE



# THE AIRPORT IN THE HEART OF EUROPE: MÜNSTER/OSNABRÜCK

**IATA: FMO**

**ICAO: EDDG**

**Muenster, Germany**

**Latitude: 52° 8′ 4″ N**

**Longitude: 7° 41′ 5″ E**

**Elevation: 160**





# GENERAL AIRPORT DATA





# GENERAL AIRPORT DATA

**Alignment: 07 / 25**

**Instrument landing system: ILS CAT IIIa (25)/  
CAT I (07)**

**Total length of runway: 2.170 m**

**Width of runway: 45 m**

**Surface: ASPH**

**Aprons:**

**30.000m<sup>2</sup> Apron West ASPH, PCN 68/F/BX/T**

**116.000m<sup>2</sup> Apron East CONC, PCN 75/R/B/W/T**

**50.000m<sup>2</sup> ASPH, PCN 75/F/B/W/T**

**Operating hours:**

**24 hours (chapter III aircraft bonus list)**





# GENERAL AIRPORT DATA

## AREA

- 200 ha Airport estate
- 150 ha of the estate is being used commercially

## CAPACITY

- 2 terminals
- Capacity for up to 3 million passengers p.a.

## CARGO

- Dedicated cargo aprons
- XXL cargo handling equipment
- Freight processing warehouse

## INFRASTRUCTURE

- 5 apron areas
- 38 Check-in counter
- 15 Gates, 5 with air bridge acces
- Capacity for 15.000 bags per hour
- 27 aircraft parking positions
- 7.000 parking lots
- Special facilities for PER, AVI, VAL
- Flexibel slot availability
- Turnaround platform with intermodal capabilities



# UP TO 40 PARKING POSITIONS

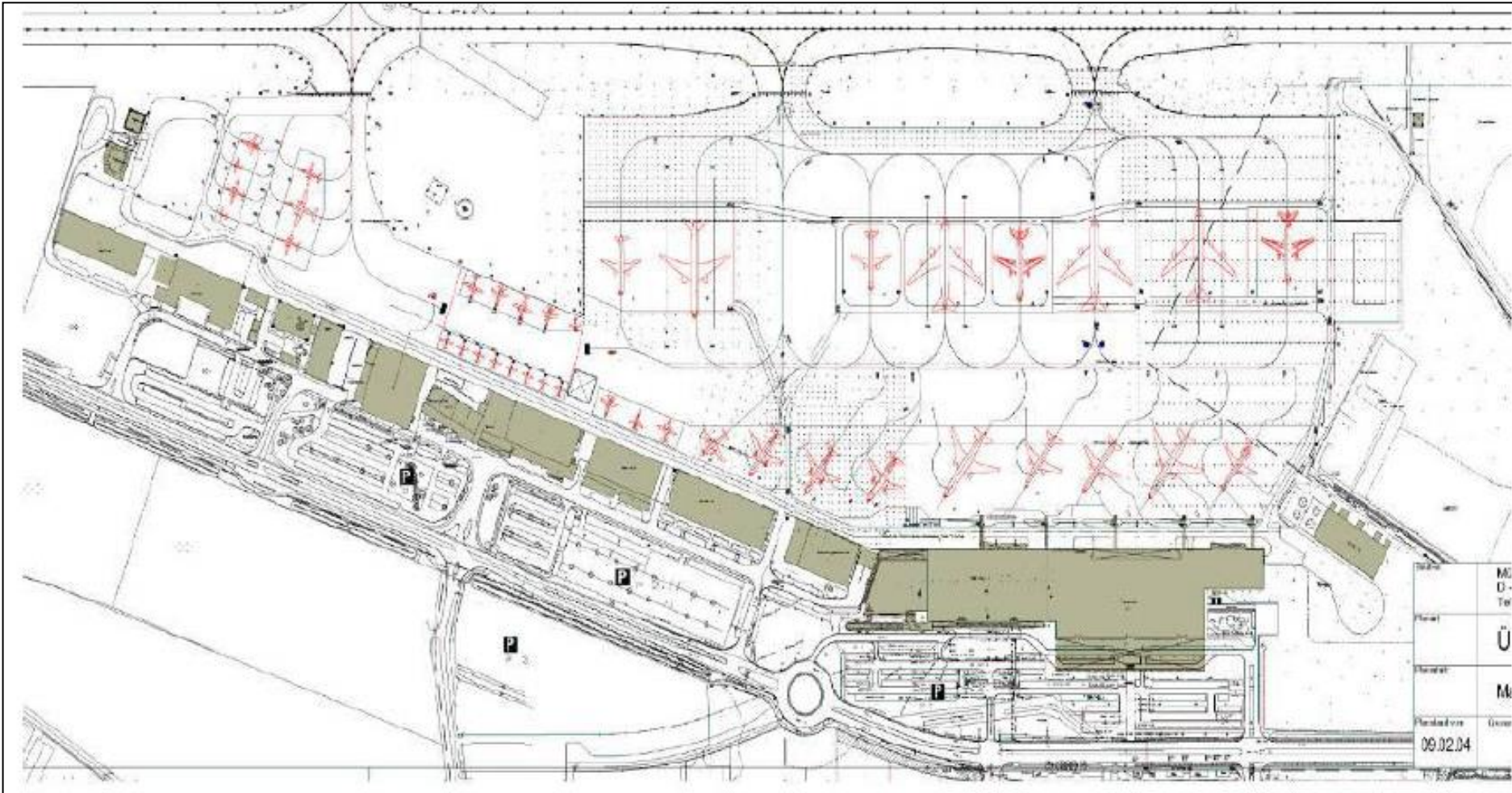



# CATCHMENT AND OPPORTUNITIES

- **Great catchment area with 3 million inhabitants** (North Rhine-Westphalia, Lower Saxony, eastern parts of the Netherlands)
- **Flexible and efficient 24-hour operation for all chapter III aircraft (bonus list)**
- **Motorway access to A1 (Hamburg–Cologne) & A30 (Amsterdam – Berlin)**
- **Appealing conditions for new airlines including marketing support**





# ADDITIONAL SERVICES AT THE AIRPORT







# CARGO SERVICES WISAG

Your partner when it comes to

- Warehousehandling
- Storage & Disposition
- Night Mail Handling
- Shipping documents





# EXCELLENT PUBLIC TRANSPORTATION BY BUS

24 hour Departures from/ to Osnabrück  
and Münster





# GENERAL AVIATION TERMINAL

**24 hour operating times with flexible slot  
availability and handling**





# PAD AVIATION TECHNICS

**On site maintenance work on planes can take place:**

- **A-Checks**
- **Aircraft Storage**
- **Enging & APU Change**
- **Cabin Modifications**
- **Delivery & Re-Delivery Checks**
- **AOG Support**
- **Durchführung von SB's, SL's & EO's**
- **A/C Exterior Cleaning**
- **A/C Interior Deep Cleaning**
- **Approvals: DE.145.0501 & BDA/AMO/530**





# CONTACTS

**For further information about the airport, conditions or charges & fees, feel free to contact us immediately.**

**FMO Flughafen Münster/Osnabrück GmbH  
Airportallee 1  
48268 Greven**

**Contact:  
Detlef Döbberthin  
Aviation Marketing  
Phone: +49 2571 94-1550  
Mail: [detlef.doebberthin@fmo.de](mailto:detlef.doebberthin@fmo.de)**

